

NOTE: DRAWINGS TO SCALE ON 24 X 36 PAPER ONLY

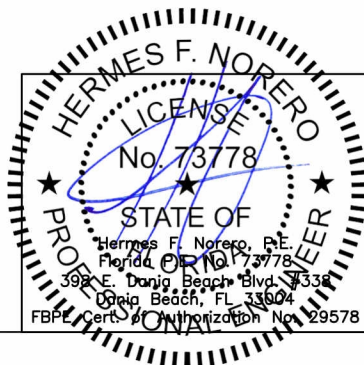

ALL SEASONS
COMMERCIAL WINDOWS & DOORS

1293 HARVEY MITCHELL PKW. BRYAN, TX 77803
PHONE: (979) 823-6557 FAX: (979) 823-1005

MEMO NO. 8043-12
DESCRIPTION:
3000 FIXED FRAME
WOOD AND MASONRY SUBSTRATE

REVISIONS		
A	EDIT DETAIL TO 2010	2/11/14

SCALE	DETAILS: FULL ELEV: 3/4" = 1"
DRAWN BY:	JKY
DATE DRAWN:	10/31/13
PAGE NO.	2 OF 4

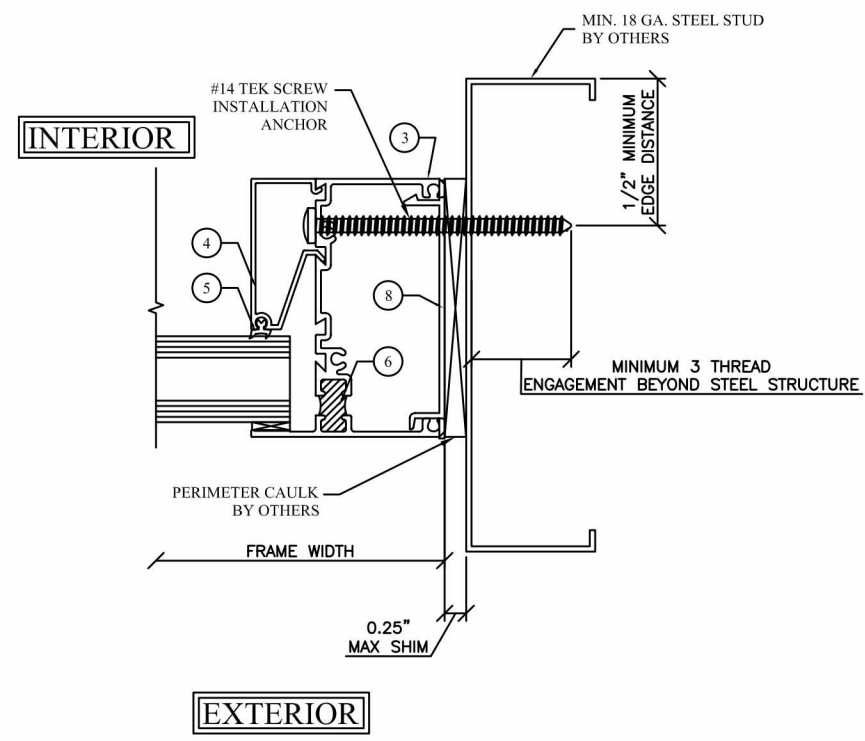
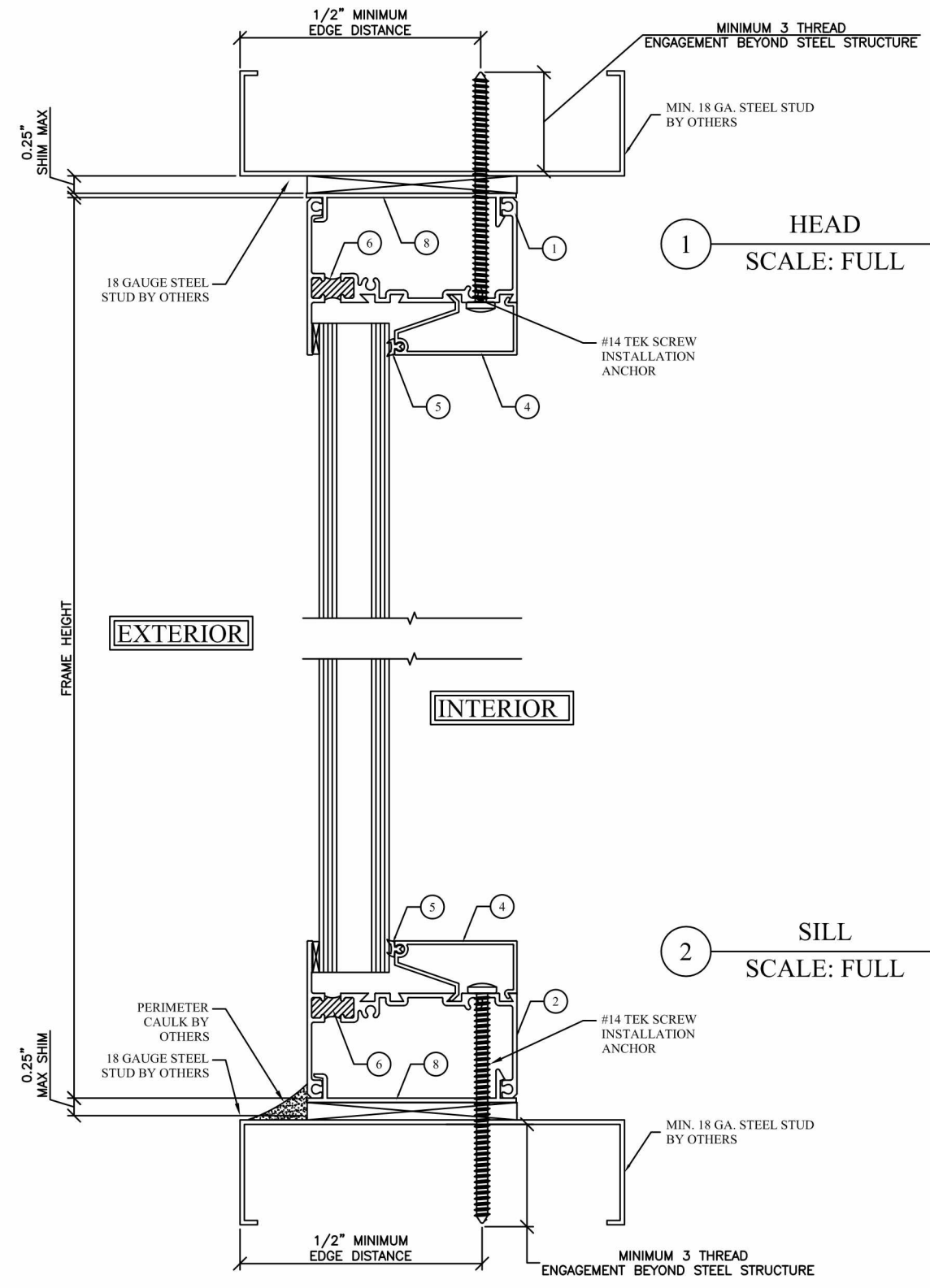

NOTE: DRAWINGS TO SCALE ON 24 X 36 PAPER ONLY

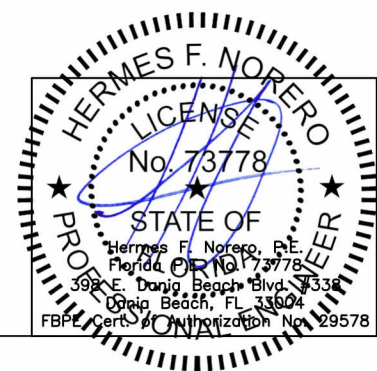

1293 HARVEY MITCHELL PKWY. BRYAN, TX 77803
 PHONE: (979) 823-6557 FAX: (979) 823-1005

MEMO NO. 8043-12

DESCRIPTION: 3000 FIXED FRAME STEEL STUD SUBSTRATE

REVISIONS		
A	EDIT DETAIL TO 2010	2/11/14

SCALE DETAILS: FULL ELEV: 3/4" = 1"

DRAWN BY: JKY

DATE DRAWN: 10/31/13

PAGE NO. 3 OF 4

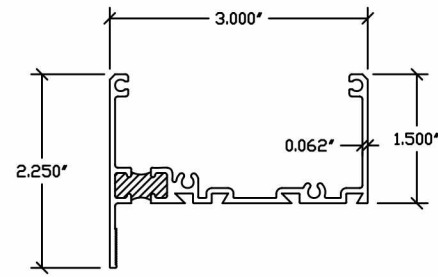

① FRAME HEAD

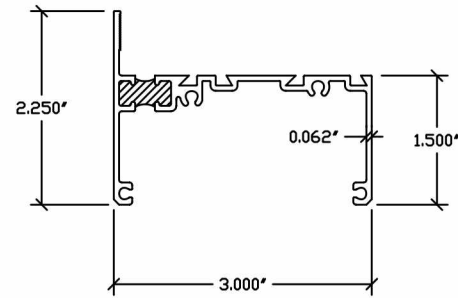

② FRAME SILL

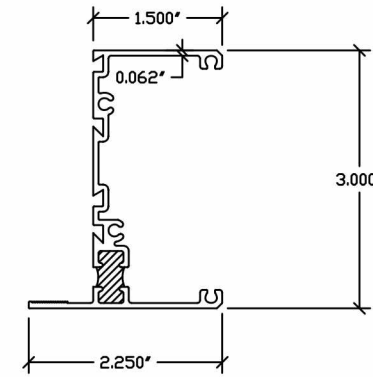

③ FRAME JAMB

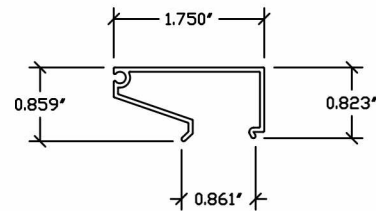

④ GLAZING BEAD

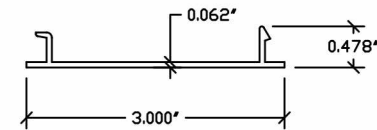

⑧ SHEAR CLIP

GLAZING DETAIL:

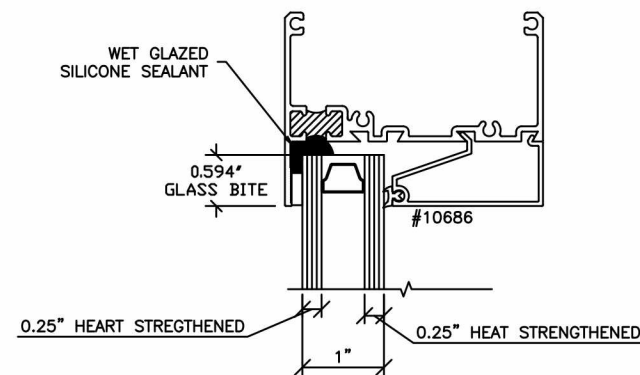

NOTE: GLASS TYPE AND THICKNESS MAY VARY ACCORDING TO THE ASTM E1300 GLASS CHART REQUIREMENTS

EXTRUSIONS

ITEM NO.	PART NO.	ITEM DESCRIPTION	MANUFACTURER / NOTES
1	10514	FRAME HEAD	6063-T5 ALUMINUM
2	10514	FRAME SILL	6063-T5 ALUMINUM
3	10514	FRAME JAMB	6063-T5 ALUMINUM
4	10686	GLAZING BEAD	6063-T5 ALUMINUM
5	63001668	GLAZING VINYL	SOFT PVC
8		SHEAR CLIP	6063-T5 ALUMINUM

SEALS & SEALANTS

ITEM NO.	PART NO.	ITEM DESCRIPTION	MANUFACTURER / NOTES
6	----	POUR & DEBRIDGE THERMAL BREAK	2 - PART POLYURETHANE

MISC. FASTENERS

ITEM NO.	PART NO.	ITEM DESCRIPTION	MANUFACTURER / NOTES
7	6#103392	#8 X 1" PH PN HD "A" CAD SCREW	FRAME ASSEMBLY SCREW

NOTE: DRAWINGS TO SCALE ON 24 X 36 PAPER ONLY

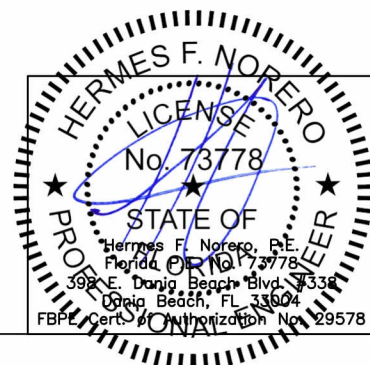

1293 HARVEY MITCHELL PKWY. BRYAN, TX 77803
 PHONE: (979) 823-6557 FAX: (979) 823-1005

MEMO NO. 8043-12

DESCRIPTION:
3000 FIXED FRAME BOM AND DIES

REVISIONS

A	EDIT DETAIL TO 2010	2/11/14

SCALE	DETAILS: FULL ELEV: 3/4" = 1"
DRAWN BY:	JKY
DATE DRAWN:	10/31/13
PAGE NO.	4 OF 4